

THE FEN THAT ATE SILVER SPRING

Capclave Guide to Restaurants within 20 Minutes by Foot

- 1) Capital Bleu -- in the Capclave hotel
major credit cards
6:00 am, 11:00 am-3:00 pm, 5:00-10:00 pm
- 2) Sergio Ristorante Italiano -- in the Capclave hotel
major credit cards
F: 11:30 am-2:00 pm; 5:00 pm-9:00pm; Sa: 5:00 pm-9:00 pm; Su closed
- 3) Ruby Tuesday's -- American sports bar, in City Place; 301-495-5845
major credit cards
F, Su: 11:00 am-11:00 pm; Su: 11:00 am-10:00 pm
- 4) Three Brothers Italian Restaurant -- also in City Place; 301-571-0111
major credit cards
F, Sa: 12:00 pm-10:00 pm; Su: 12:00 pm-8:30 pm
- 5) City Place is an enclosed mall, open from 10:00 am to 9:00 pm Fridays and Saturdays and noon to 6:00 on Sundays, just up the street from the Capclave hotel. On its basement level, City Place has a food court containing fast food and steam table establishments: The Brass Hen (fried chicken); Burger King; TCBY (ice cream substitutes); China City; Yenni's Dim Sum; Subway; Taco Uno; and Villa Pizza.
- 6) Da Marco's Italia Gourmet -- Italian carryout; 301-588-6999
F: 9:30 am-6:00 pm; Sa: 9:30 am-6:00 pm; Su: closed
- 7) Panchito Restaurant -- Salvadoran/Mexican (free delivery); 301-565-4985
D, MC, V
7:00 am-11:00 pm
- 8) Ming House -- Chinese (free delivery); 301-588-6666
F, Sa: 11:30 am-11:30 pm; Su: 12:00-10:30 pm
- 9) Crisfield Seafood at Lee Plaza -- 301-588-1572
major credit cards
F: 11:30 am-11:00 pm; Sa: 11:00 am-11:00 pm; Su: 2:00 pm-9:30 pm
- 10) Jerry's Sub Shop -- pizza and sandwiches; 301-588-9110
AmEx, MC, V
F: 8:00 am-12:00 pm; Sa: 10:00 am-12:00 pm; Su: 11:00 am-9:00 pm
- 11) Golden Flame -- Greek/meat and potatoes; 301-588-7250
AmEx, MC, V
F: 11:30 am-10:00 pm; Sa: 4:00 pm-10:00 pm; Su closed
- 12) El Texano -- Salvadoran/Mexican; 301-587-6335
F: 11:30 am-3:00 pm; 6:00 pm-1:00 am; Sa: 11:30 am-1:00 am; Su 11:00 am-1:00 am
- 13) River City Grill -- upscale at Silver Spring's other downtown hotel; 301-589-0800
major credit cards
F: 6:30 am-10:00 pm; Sa, Su 7:00 am-10:30 pm
- 14) Tastee Diner -- American diner; the transplanted but still-beating heart of Silver Spring; 301-589-8171
AmEx, MC, V
OPEN 24/7
- 15) Mi Rancho -- TexMex; 301-588-4872
AmEx, MC, V
F, Sa: 11:30 am-11:00 pm; Su: 11:30 am-10:00 pm
- 16) Cubano's -- Cuban/Caribbean; 301-563-4020
AmEx, D, MC, V
F: 11:30 am-10:00 pm; Sa, Su: 1:00 pm-10:00 pm

17) Carolina Kitchen -- southern American;
301-585-4400
AmEx, MC, V
F, Sa: 11:00 am-10:00 pm; Su: 12:00 pm-9:00 pm

18) Omega Restaurant and Carryout --
301-587-3187; wheelchair hostile
D, MC, V
F, Sa, Su: 10:00 am-1:00 am

19) McDonald's -- Scottish cuisine; 301-588-3386
F: 5:00 am-12:00 pm; Sa: 6:00 am-12:00 pm; Su:
7:00 am-11:00pm

20) Einstein Brothers Bagels -- tough toroidal
cuisine; 301-587-2136
F: 6:00 am-5:00 pm; Sa, Su: 7:00 am-5:00 pm

21) Starbucks -- coffee; 301-563-6850
major credit cards
F: 6:00 am-9:00 pm; Sa: 6:00 am-9:30 pm; Su: 7:00
am-7:30 pm

22) Oriental East -- Chinese; excellent dim sum on
Saturdays and Sundays; expect to wait in line;
301-608-0030
major credit cards
F, Sa: 11:00 am-11:00pm; Su: 11:00 am-10:00 pm

23) Caribbean Style Restaurant -- carryout and
sit-down; 301-585-5496
major credit cards
F: 11:00 am-10:00 pm; Sa: 11:00 am-10:00 pm; Su:
1:30 pm-8:00 pm

24) Pike Pizza II -- Bolivian and sandwiches;
301-587-2788
AmEx, D, MC, V
F: 11:00 am-10:00 pm; Sa: 11:00 am-10:00 pm
live entertainment

25) China Restaurant -- Chinese sit-down and
carryout (free delivery); 301-565-2528
AmEx, MC, V
F, Sa, Su: 11:00 am-11:00 pm

26) Bombay Gaylord -- Indian; 301-565-2528
AmEx, MC, V
F: 11:30 am-3:00 pm; 5:00 pm-9:30 pm; Sa, Su:
12:00 pm-3:00 pm; 5:00 pm-9:30 pm

27) Quarry House Tavern -- bar with sandwiches;
301-587-9406; wheelchair hostile
F: 11:00 am-12:00 am; Sa: 5:00 pm-12:00 am; Su
closed

28) Kefa Cafe -- coffee shop with sandwiches,
pastries; 301-589-9337
major credit cards
F: 7:00 am-6:00 pm; Sa: 8:00 am-5:00 pm; Su closed

29) Roger Miller -- West African; 301-650-2495;
wheelchair hostile
D, MC, V
F: 12:00 am-2:00 pm; Sa: 12:00 pm-?; Su 12:00 pm-
11:30 pm

30) Thai Derm -- 301-589-5341; wheelchair hostile
D, MC, V
F: 11:00 am-10:00 pm; Sa: 12:00 pm-9:30 pm; Su:
5:00 pm-9:30 pm

31) Langan's Ethiopian -- 301-571-6111
AmEx, MC, V
F, Sa: 7:30 am-2:00 am; Su: 1:00 pm-12:00 am

32) Negril Jamaican Bakery and Eatery
MC, V
F, Sa: 11:00 am-10:00 pm; Su closed

33) La Bamba -- Salvadoran; 301-589-3712
MC, V
F, Sa: 11:00 am-11:00 pm; Su: 11:00 am-9:45 pm

34) Half Moon BBQ -- barbeque; 301-585-1290
no credit cards
F, Sa: 5:30 pm-1:45 am; Su closed
live entertainment

35) Rodeo -- TexMex; 301-585-2955
AmEx, MC, V
F, Sa: 11:00 am-1:00 am; Su: 12:00 pm-11:00 pm

36) Tijuana's Mexican Cafe -- 301-562-9336
AmEx, MC, V
Sa: 11:00 am-1:00 am; Su: 11:00 am-12:00 pm

37) Thai Spice -- 301-589-8233
MC, V
F, Sa: 11:00 am-3:00 pm; 5:00 pm-9:30 pm; Su
closed

38) Chicken and Steak -- Peruvian; 301-650-0066
MC, V
F, Sa: 11:00 am-?; Su: 11:00 am-10:00 pm

39) Gourmet Polonez Deli -- deli; 301-495-2650
F: 7:30 am-6:30 pm; Sa: 7:30 am-5:30 pm; Su closed

40) Vicino Ristorante Italiano -- 301-588-3372
MC, V
F: 11:30 am-10:30 pm; Sa: 12:30 pm-10:30 pm; Su:
1:00 pm-9:30 pm

41) Phoenix of China

42) My Le Vietnamese Cuisine -- 301-588-8305
MC, V
F, Sa, Su: 11:00 am-10:00 pm

43) Dragon City Restaurant and Carryout -- Chinese
(free delivery); 301-565-8850
MC, V
F: 11:00 am-12:00 pm; Sa, Su: 11:00 am-1:00 pm

44) Manny and Olga's -- carryout pizza, sandwiches
(free delivery); 301-608-8050
major credit cards
F, Sa: 1:00 am-12:00 pm; Su: 10:00 am-11:00 pm

45) Fresh Starts -- American; 301-587-6677
F: 9:00 am-4:00 pm; Sa: 6:00 am-2:00 pm

46) Thai Market and Carryout -- 301-495-2779
major credit cards
F, Sa: 9:30 am-7:30 pm; Su: 9:30 am-6:30 pm

47) Golden House -- carryout Chinese (free
delivery); 301-495-8888
F, Sa: 11:00 am-12:30 am; Su: 12:00 pm-11:00 pm

48) Formerly Montgomery Donuts -- soft toroidal
cuisine

49) Baja Fresh -- TexMex wraps and tacos
AmEx, MC
F, Sa: 11:00 am-10:00 pm; Su: 11:00 am-9:00 pm

A) Mariam Grocery -- African, Central and South
American groceries
AmEx, MC, V

B) Aztec Bodega -- Hispanic groceries
F, Sa: 9:00 am-9:00 pm; Su: 12:00 pm-6:00 pm

C) La Hispaniola Market -- Hispanic groceries
MC, V
F, Sa: 9:00 am-?; Su closed

D) Muskan Natural Foods
AmEx, D, MC, V
F, Sa: 10:00 am-7:00 pm; Su closed

E) Ethiopian/Indian Super Market
F, Sa: 10:00 am-10:00 pm; Su: 10:00 am-9:00 pm

F) Safeway -- groceries
major credit cards
F, Sa, Su: 6:00 am-12:00 am

G) Ecology Health Food Mart
MC, V
F: 8:00 am-7:00 pm; Sa: 8:00 am-7:00 pm; Su closed

H) Whole Foods -- Yuppy groceries; formerly Fresh
Fields; has attached coffee shop
major credit cards
F: 9:00 am-10:00 pm; Sa: 8:00 am-10:00 pm; Su:
8:00 am-9:00 pm

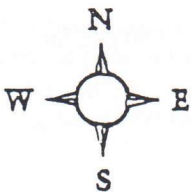
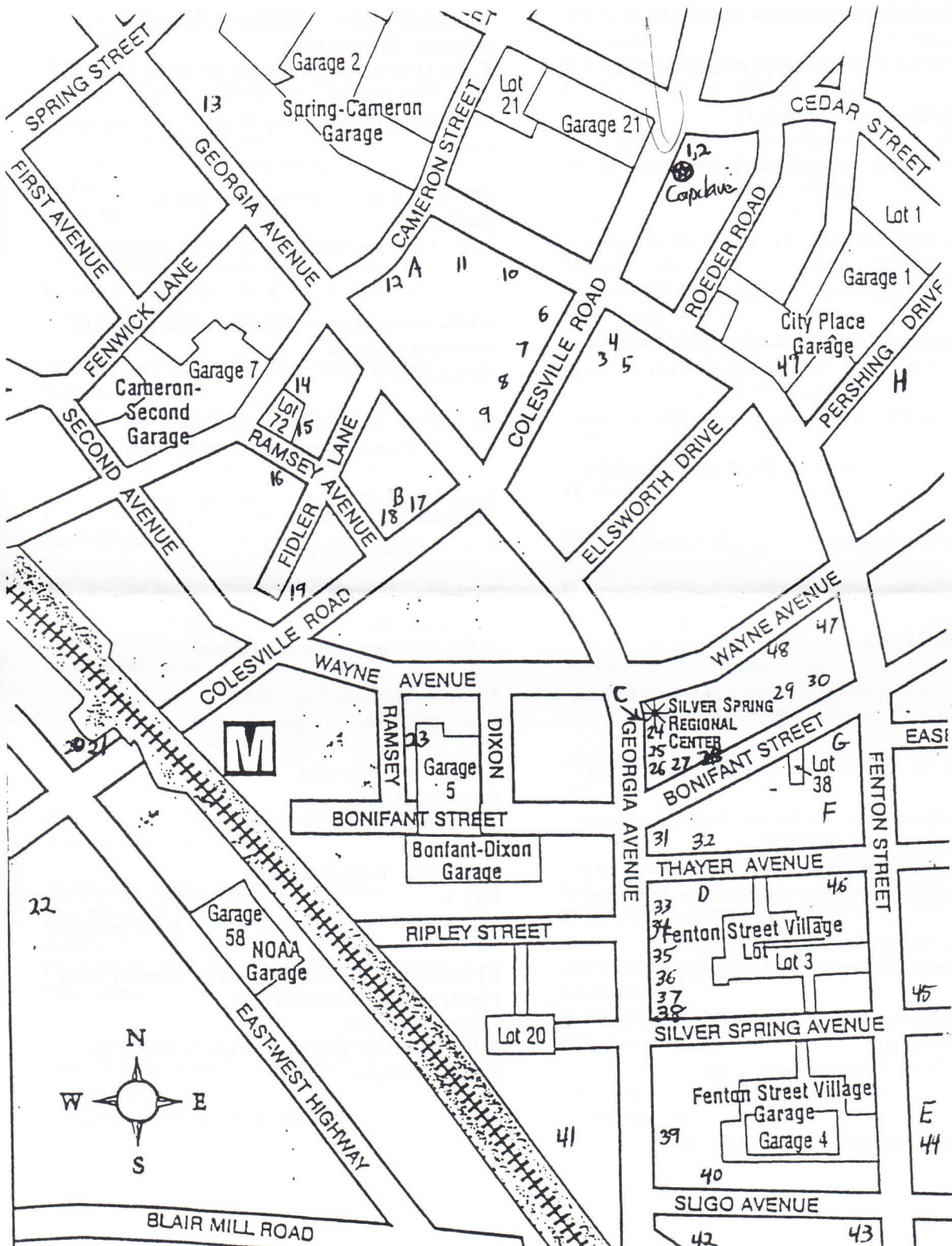

M

SILVER SPRING
24 REGIONAL
25 CENTER
26 27 28

Fenton Street Village
Lot 3

Fenton Street Village
Garage 4